

ZRA (STANDARD SWIVEL JOINTS)

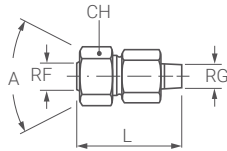

ZRA 1212 B1



STANDARD SWIVEL JOINTS

ZRA/ZRB/ZRC are standard swivel joints for manufacturing plants requiring product diversification. The fitting and adjustment of the joints can be done easily by tightening the hexagonal screw cap.

TYPICAL APPLICATIONS

Cleaning equipment used in pre-treatment for coating process
Continuous casting cooling

INLET THREAD SIZE
OUTLET THREAD SIZE
MAX WORKING PRESSURE
MATERIAL

1/8", 1/4", 3/8", 1/2", 3/4"

LP 21 bar
B1 AISI 303 Stainless Steel
B31 AISI 316L Stainless Steel
T1 Brass

CODE	RG inch	RF inch	L mm	A deg	CH mm	W g
ZRA 1212 xx YZ	1/8"	1/8"	38	50°	22	57
ZRA 2525 xx YZ	1/4"	1/4"	59	50°	22	75
ZRA 3838 xx YZ	3/8"	3/8"	72	50°	27	155
ZRA 5050 xx YZ	1/2"	1/2"	82	50°	27	186
ZRA 7575 xx YZ	3/4"	3/4"	92	50°	41	468

CODE	RF inch	RF inch	L mm	A deg	CH mm	W g
ZRB 1212 xx YZ	1/8"	1/8"	29	50°	22	57
ZRB 2525 xx YZ	1/4"	1/4"	49	50°	22	75
ZRB 3838 xx YZ	3/8"	3/8"	52	50°	27	155
ZRB 5050 xx YZ	1/2"	1/2"	72	50°	27	186
ZRB 7575 xx YZ	3/4"	3/4"	85	50°	32	468

CODE	RF inch	L mm	A deg	CH mm	W g
ZRC 1212 xx YZ	1/8"	32	50°	22	57
ZRC 2626 xx YZ	1/4"	67	50°	27	147
ZRC 7575 xx YZ	3/4"	92	50°	32	468

HOW TO MAKE UP THE PRODUCT CODE

ZRx 1212 xx Y Z

- THREAD**
 - B - BSP (female), BSPT (male)
 - N - NPT
- VARIANT**
 - S - Standard (three parts)
 - R - Reduced (two parts)
- MATERIAL**
 - B1 - AISI 303 Stainless Steel
 - B31 - AISI 316L Stainless Steel
 - T1 - Brass
- INLET THREAD SIZE**
 - 12 - 1/8"
 - 25 - 1/4"
 - 38 - 3/8"
 - 50 - 1/2"
 - 75 - 3/4"
- OUTLET THREAD SIZE**
 - 12 - 1/8"
 - 25 - 1/4"
 - 38 - 3/8"
 - 50 - 1/2"
 - 75 - 3/4"

NOZZLE TYPE	INLET	OUTLET
ZRA	Male	Female
ZRB	Female	Female
ZRC	Welded	Female

